

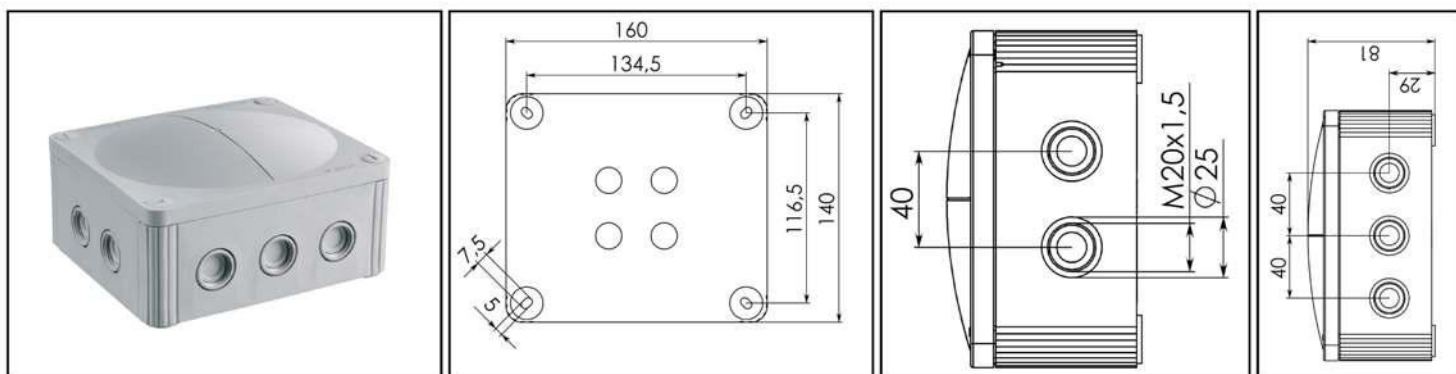







## WISKA COMBI 1210

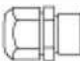

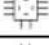
<b>Protection class to EN 60 529:</b>	IP 66/67
<b>Flame protection:</b>	Glow wire test 750 C acc. to EN 60695-2-11
<b>Temperatures during installation:</b>	-5°C to 60°C
<b>Temperature range of material:</b>	-30°C to 100°C, intermittent up to approx. 120°C
<b>Voltage:</b>	690 V
<b>Material:</b>	Polypropylene, reinforced; Sealing: thermoplastic elastomere
<b>Terminals/poles:</b>	10 mm <sup>2</sup>
<b>Fixing:</b>	4 internal openings outside of the sealing area
<b>Equipment:</b>	<ul style="list-style-type: none"> <li>- 10 M 20 inputs with elastic soft membrane and thread, and M 25 breakout opening</li> <li>- 4 inputs with self-sealing ground membrane</li> <li>- 4 captive quick-release lid screws</li> <li>- Colour RAL 7035 light grey</li> <li>- .../S = black</li> <li>- .../W = white</li> </ul>

Type	WISKA-No.		 mm		L x B x H external / mm
COMBI 1210/leer	10101459	2	3 - 12		160 x 140 x 81
COMBI 1210/leer/S	10101460	2	3 - 12		160 x 140 x 81
COMBI 1210/leer/W	10101461	2	3 - 12		160 x 140 x 81
COMBI 1210/5	10101462	2	3 - 12		160 x 140 x 81
COMBI 1210/5/S	10101463	2	3 - 12		160 x 140 x 81
COMBI 1210/5/W	10101464	2	3 - 12		160 x 140 x 81
DIN RAIL KIT 1210	10101478	1	-	-	-